

OPERATOR'S MANUAL

Carry-All Ejection Scraper



Put DIRT in its place.

MODEL

GCA1250HC

1250 CARRY ALL

Operator's Manual

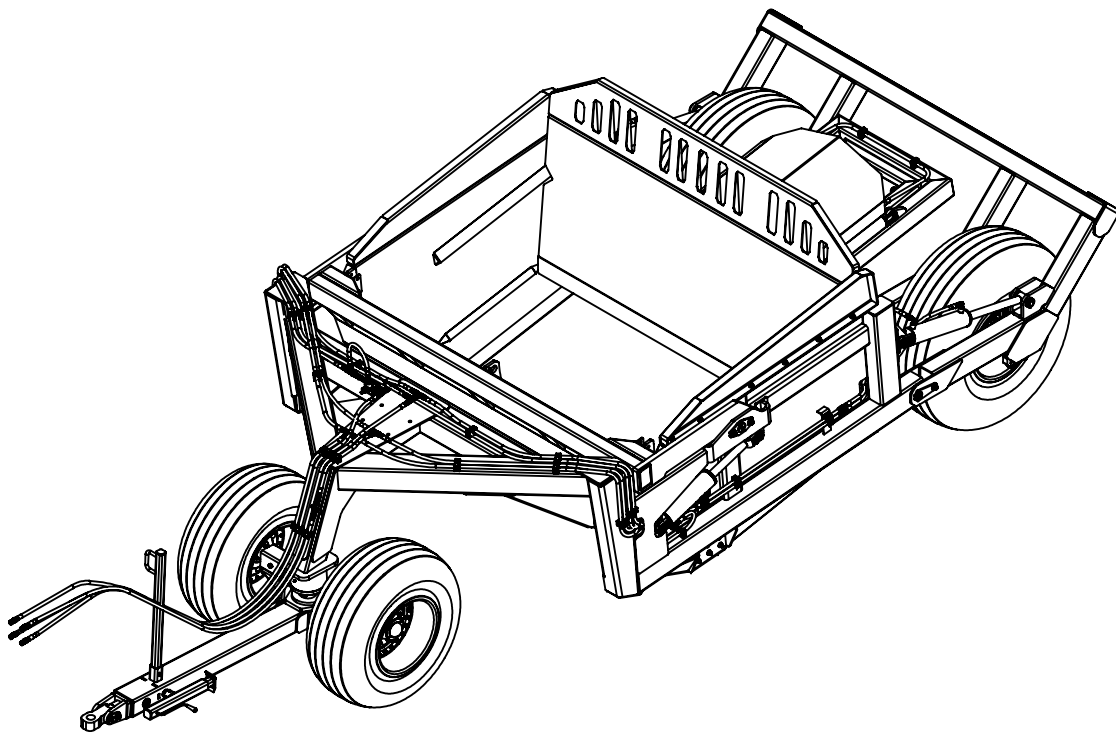

12.5 YD. CU., DOLLY





TABLE OF CONTENTS

| | |
|-------------------------------------|----|
| INTRODUCTION | 2 |
| IMPORTANT SAFETY INFORMATION | 3 |
| BE AWARE OF SIGNAL WORDS | 3 |
| PREPARE FOR EMERGENCIES | 4 |
| SHUTDOWN AND STORAGE | 4 |
| ASSEMBLY AND SET-UP | 4 |
| PARTS MANUAL | 4 |
| 1250 HYDRAULIC SYSTEM | 9 |
| DRAWBAR HOOK-UP | 11 |
| OPERATION | 12 |
| SETTING THE VALVES | 12 |
| BLADES | 13 |
| WARRANTY | 14 |



INTRODUCTION

Welcome! You are now the owner of one of the most versatile machines for landscaping, terracing and earth moving. In years to come, your farm or ranch operation will benefit from the efficiency, utility, and economy provided by the GARFIELD SCRAPER.

This CA1250 model has been designed with the most modern methods and built by skilled workers using quality materials.

Please take time to be sure that you understand the proper maintenance and safe operation of this machine. Read this manual and follow the recommendations to help ensure safe and efficient operation. Also, keep this manual handy for future reference.

The information contained within this manual was current at the time of printing. Some parts may change slightly to assure you of the best performance.

To order a new Operator's or Parts Manual contact your authorized dealer.

GARFIELD EQUIPMENT, INC., provides warranty on each new machine sold. Be sure to fill out the warranty card and return it to GARFIELD EQUIPMENT, INC., within 10 days after delivery of your machine to be eligible for this warranty. If you did not get a warranty card with your machine, contact your Dealer to receive one. GARFIELD EQUIPMENT INC. will not provide warranty on any machine that has been altered or used for something other than its intended use.

GARFIELD EQUIPMENT INC., reserves the right to make any changes, or add improvements to its products at any time without incurring any obligation to make such changes on previously manufactured equipment.

GARFIELD EQUIPMENT, INC.

500 W. SOUTHGATE

ENID, OKLAHOMA 73701

580-233-1410

800-382-4478

IMPORTANT SAFETY INFORMATION

Thoroughly read and understand the instructions given in this manual before operation. Refer to the "Safety Label" section, read all instructions noted on them.

Do not allow anyone to operate this equipment who has not fully read and comprehended this manual and who has not been properly trained in the safe operation of the equipment.

Operate equipment from the driver's seat only and do not lubricate, adjust or repair when machine is in motion.

Do not leave tractor or equipment unattended with engine running.

Do not allow anyone to stand between tractor and equipment while backing up to equipment. Keep hands, feet, and clothing away from power-driven parts. Wear snug fitting clothing to avoid entanglement with moving parts.

Do not carry passengers on equipment at any time.

Turning tractor too tight may cause equipment to ride up on wheels. This could result in injury or equipment damage.

Dismounting from a moving tractor could cause serious injury or death.

Should hydraulic hoses and/or fitting be accidentally damaged, replace those components for safe operation. Never open hydraulic components under pressure.

BE AWARE OF SIGNAL WORDS

A signal word designates a degree or level of hazard seriousness. The signal words are:



DANGER

Indicates an imminently hazardous situation which, if not avoided, will result in death or serious injury. This signal word is limited to the most extreme situations, typically for machine components that, for functional purposes, cannot be guarded.



WARNING

Indicates a potentially hazardous situation which, if not avoided, could result in death or serious injury, and includes hazards that are exposed when guards are removed. It may also be used to alert against unsafe practices.



CAUTION

Indicates a potentially hazardous situation which, if not avoided, may result in minor or moderate injury. It may also be used to alert against unsafe practices.

PREPARE FOR EMERGENCIES

Be prepared if a fire starts.

Keep a first aid kit and fire extinguisher handy.

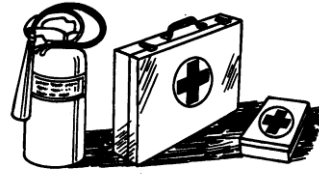

Keep emergency numbers for doctor, ambulance, hospital and fire department near phone.

SHUTDOWN AND STORAGE

Lower machine to ground, put tractor in park, turn off engine, and remove the key. Detach and store implements in an area where children normally do not play. Secure equipment by using blocks and supports.

ASSEMBLY AND SET-UP

PARTS MANUAL

1250 scrapers are delivered fully assembled, but you can have a reference in the next diagrams.

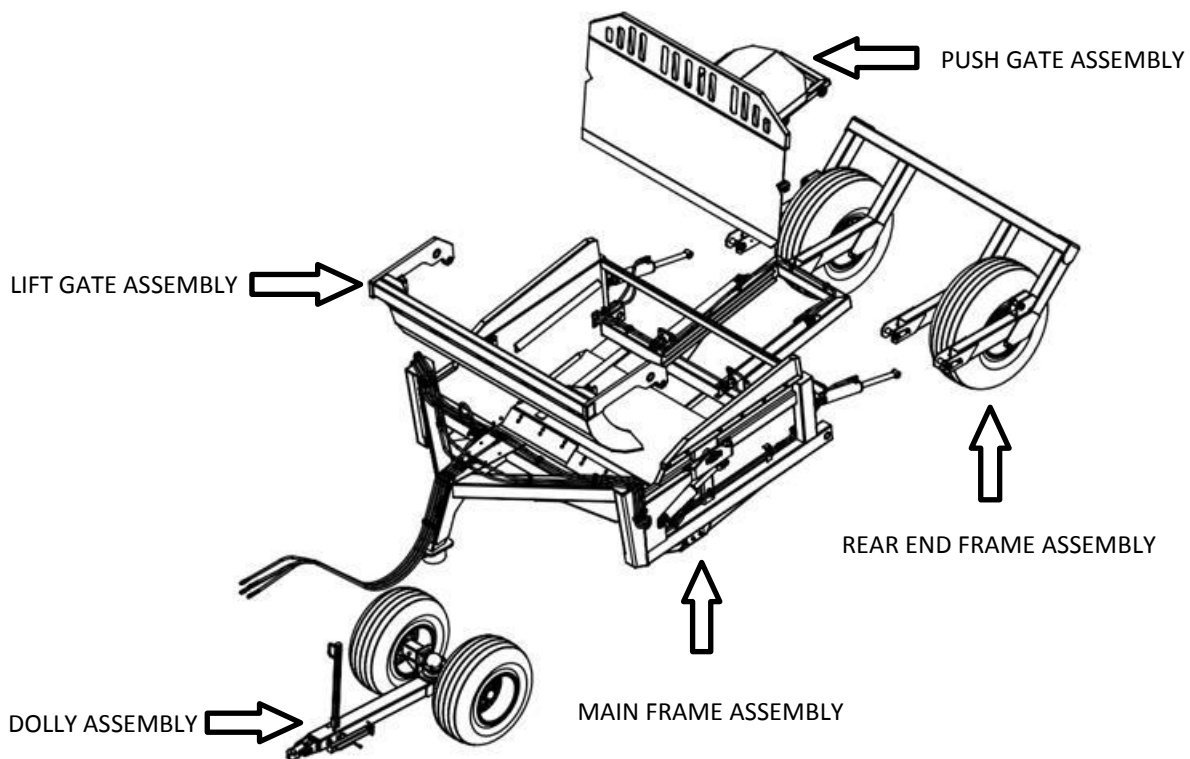

IMPORTANT: Parts must be ordered through your local authorized Garfield dealer. Be sure to state MODEL and SERIAL NUMBER of the machine, PART NUMBER, DESCRIPTION and QUANTITY needed.

MAIN FRAME ASSEMBLY

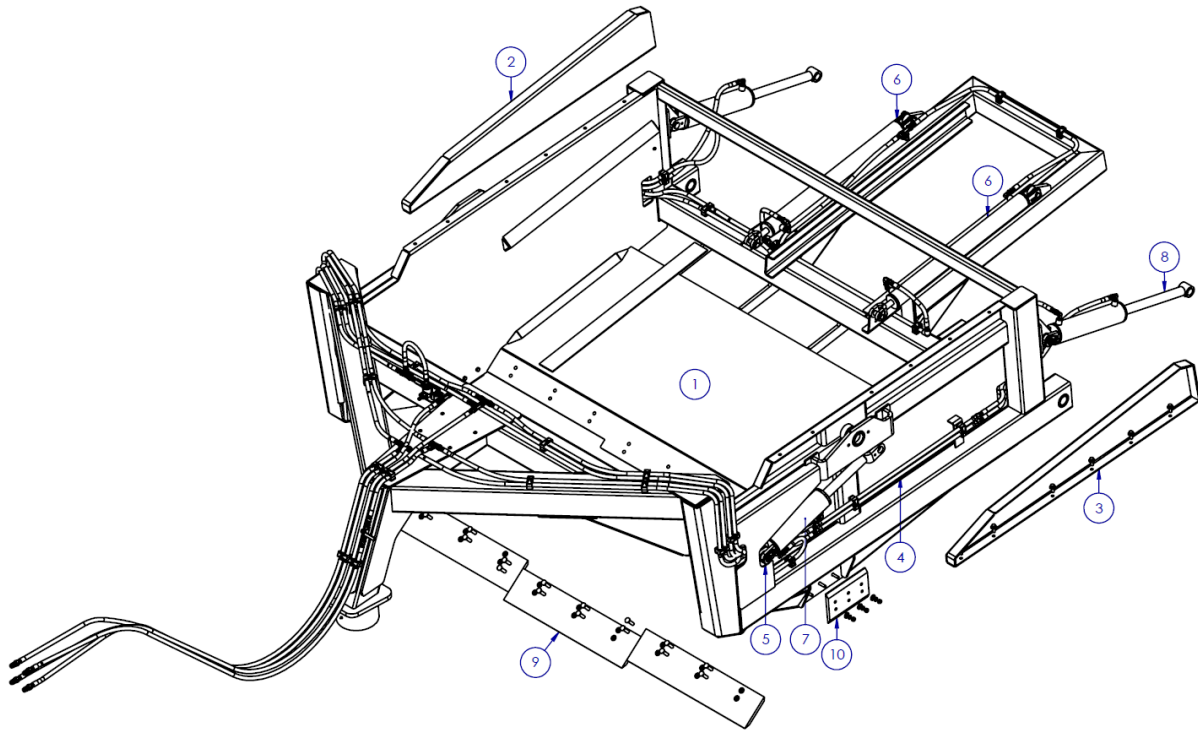

| ITEM | PART # | DESCRIPTION | QTY. |
|------|----------------|--|------|
| 1 | GBCA12040100W | CA1250 MAIN FRAME, ASSEMBLY | 1 |
| 2 | GBCA12040600W | RIGHT SPOILER | 1 |
| 3 | GBCA12040700W | LEFT SPOILER | 1 |
| 4 | GBCA12050009C | SIDE TUBE | 7 |
| 5 | GBCA12051000W | CYLINDER PIN ASSY | 4 |
| 6 | SP4110-4050-01 | 3" X 36" X 1-1/2" STROKE HYD CYL (HCY3X36X112) | 2 |
| 7 | SP4110-4094-01 | 4" X 12" X 2" STROKE HYD CYL (HCY4X12X2) | 2 |
| 8 | SP4110-4098-01 | 4" X 16" X 2" STROKE HYD CYL (HCY4X16X2) | 2 |
| 9 | SP4370-1321-00 | BLADE 3/4" X 8" X 36" RB (GCARB3RB) | 3 |
| 10 | SP4370-1340-00 | G.CARRY ALL SIDE WEAR BLADES NEW (GCASWBN) | 2 |

DOLLY ASSEMBLY

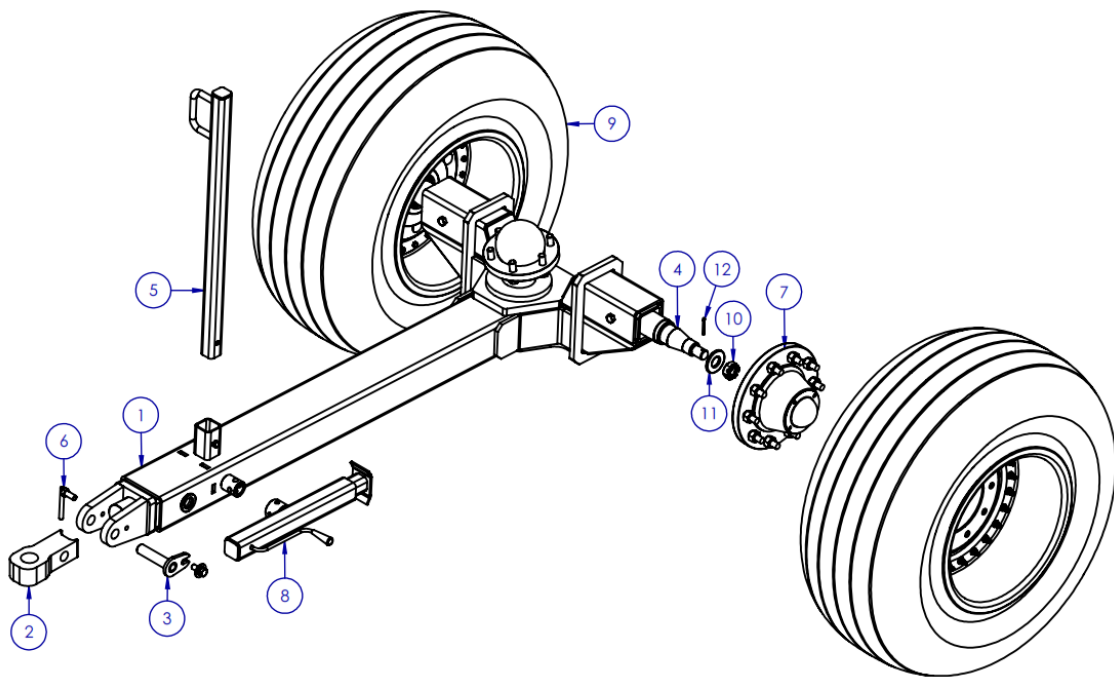

| ITEM | PART # | DESCRIPTION | QTY. |
|------|----------------|---|------|
| 1 | GBCA12040500W | DOLLY ASSEMBLY | 1 |
| 2 | GBCA12040001C | LARGE 2" HOLE PULL BLOCK | 1 |
| 3 | GBCA12051100W | HITCH PIN | 1 |
| 4 | GBCA12050007C | FRONT SPINDLE | 2 |
| 5 | GBCA12011300W | HOSES SUPPORT | 1 |
| 6 | GBCA12051400W | PULL BLOCK LOCK | 1 |
| 7 | SP4190-0015-25 | W871 HUB W/CUPS AND STUDS/COMPLETE (WHBW871) | 2 |
| 8 | SP4190-1080-00 | 10" TUBE MT JACK 5000# (JK105) | 1 |
| 9 | SP4330-2540-01 | H46 X 18-20 TIRE AND WHEEL (TIRE18) | 2 |
| 10 | SP4220-1022-26 | SPINDLE NUT FOR FRONT 12 YD CA ASSY (WSNW871) | 2 |
| 11 | SP4240-1036-04 | SPINDLE WASHER FOR W871 HUB (WCPW871) | 2 |
| 12 | SP4260-1122-01 | COTTER PIN 1/4" X 2" FOR W871 HUB (WCPW871) | 2 |

LIFT GATE ASSEMBLY

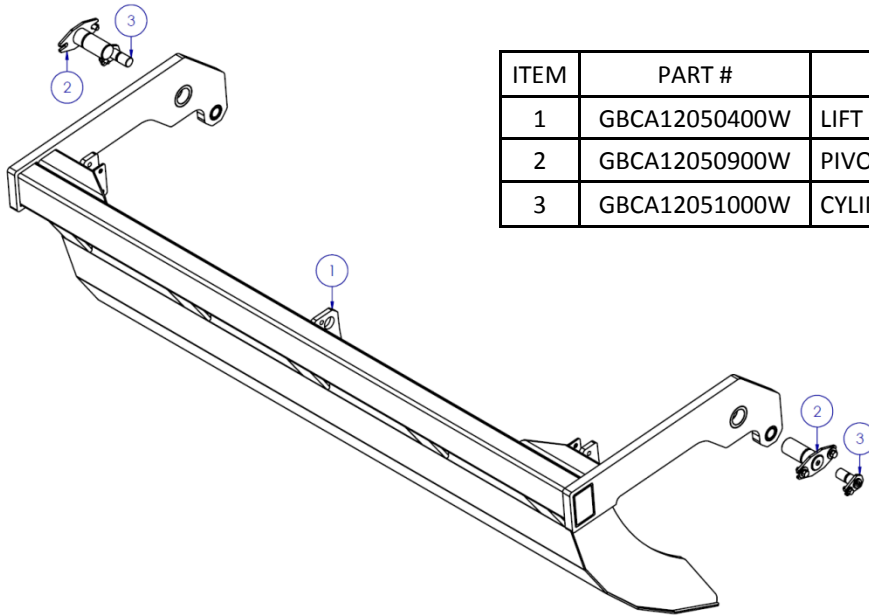

| ITEM | PART # | DESCRIPTION | QTY. |
|------|---------------|--------------------|------|
| 1 | GBCA12050400W | LIFT GATE ASSEMBLY | 1 |
| 2 | GBCA12050900W | PIVOT PIN ASSY | 2 |
| 3 | GBCA12051000W | CYLINDER PIN ASSY | 2 |

PUSH GATE ASSEMBLY

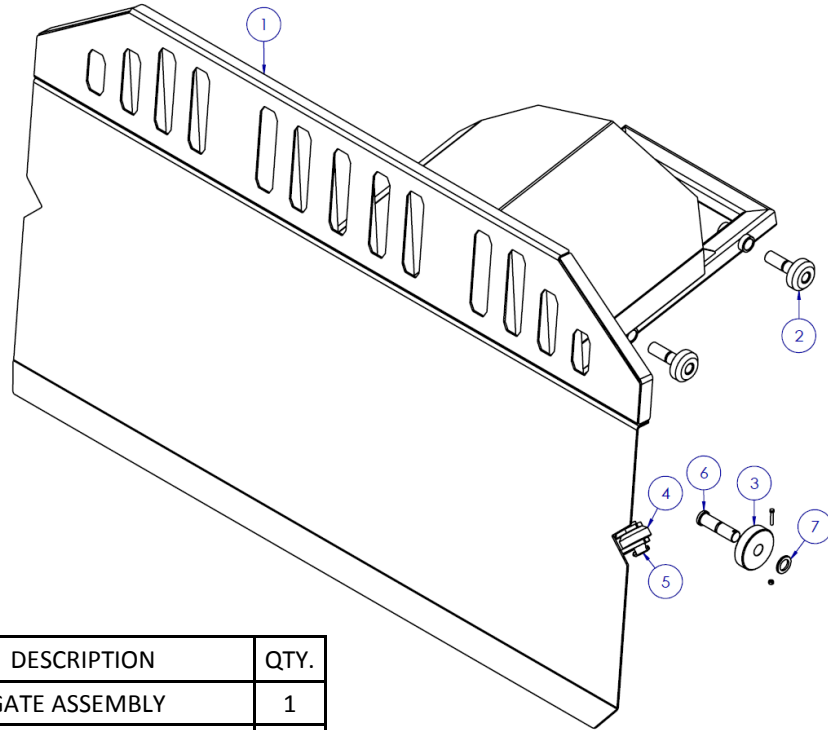

| ITEM | PART # | DESCRIPTION | QTY. |
|------|---------------|--------------------|------|
| 1 | GBCA12040300W | PUSH GATE ASSEMBLY | 1 |
| 2 | GBCA12011200W | ROLLER W/PIN | 4 |
| 3 | GBCA12010005C | ROLLER | 2 |
| 4 | GBCA12010006C | SIDE ROLLER | 2 |
| 5 | GBCA12010901C | 4" LONG PIN | 2 |
| 6 | GBCA12011001C | 6" LONG PIN | 2 |
| 7 | GBCA12010517C | ROLLER PIN WASHER | 2 |

REAR END FRAME ASSEMBLY

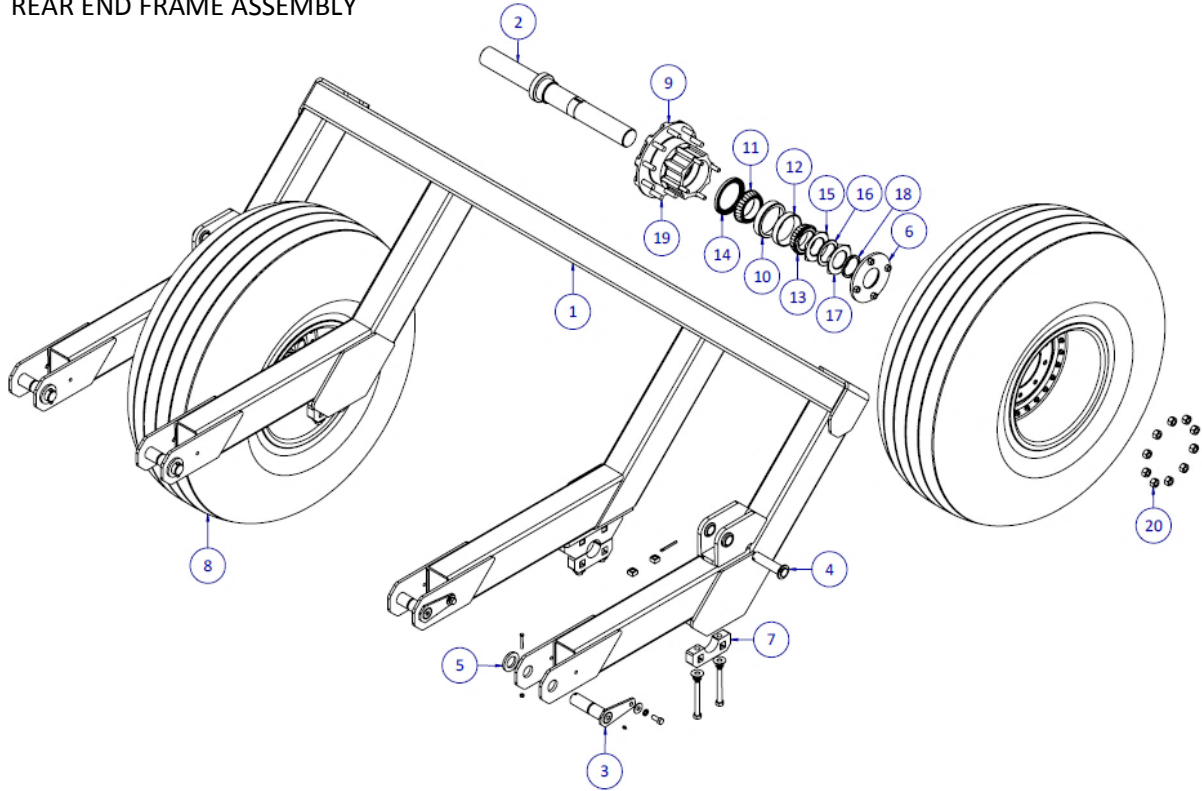

| ITEM | PART # | DESCRIPTION | QTY. |
|------|----------------|---|------|
| 1 | GBCA12040200W | REAR END FRAME, ASSEMBLY | 1 |
| 2 | GBCA12050600W | SPINDLE, ASSEMBLY (WSPQ900S) | 2 |
| 3 | GBCA12051200W | PIN FOR HINGE | 4 |
| 4 | GBCA12010800W | 6-1/2" LONG PIN | 2 |
| 5 | GBCA12010004C | 1/2" WASHER | 4 |
| 6 | GBCA12010011C | DUST CAP (WDCQ900S) | 2 |
| 7 | GBCA12050005C | CLAMP | 4 |
| 8 | SP4330-2090-01 | 20 X 20 FOR 12 YD CA (TIRE 20X20) | 2 |
| 9 | SP4380-1025-05 | S900 HUB FOR REAR 12 YD CA (WHBQ900S) | 2 |
| 10 | SP4150-7985-00 | 12 YD INNER RACE REAR AXLE (592 A) | 2 |
| 11 | SP4150-1985-00 | INNER BEARING FOR REAR 12 YD CA HUB (594 A) | 2 |
| 12 | SP4150-7950-00 | 12 YD OUTER RACE REAR AXLE (572) | 2 |
| 13 | SP4150-1950-00 | OUTER BEARING FOR REAR 12 YD CA HUB (580) | 2 |
| 14 | SP4130-5131-00 | INNER SEAL FOR REAR 12 YD CA HUB (NAT370003A) | 2 |
| 15 | SP4220-1050-22 | SPINDLE INNER NUT FOR REAR 12 YD CA (06-411)(WSINQ900S) | 2 |
| 16 | SP4240-1064-04 | SPINDLE WASHER FOR REAR 12 YD CA HUB (WWSQ900S) | 2 |
| 17 | SP4220-1051-22 | SPINDLE OUTER NUT FOR REAR 12 YD. CA (06-412) (WSONQ900S) | 2 |
| 18 | SP4130-5130-00 | OUTER SEAL FOR 900S HUB 12 YD (NAT416404) (WOSQ900S) | 2 |
| 19 | SP4210-1458-96 | STUD FOR REAR 12 YD CA HUB (13-1203 R OR L) WSTQ900S) | 20 |
| 20 | SP4220-1014-98 | LUG NUT FOR REAR 12 YD CA HUB (WLNQ900S) | 20 |

1250 HYDRAULIC SYSTEM

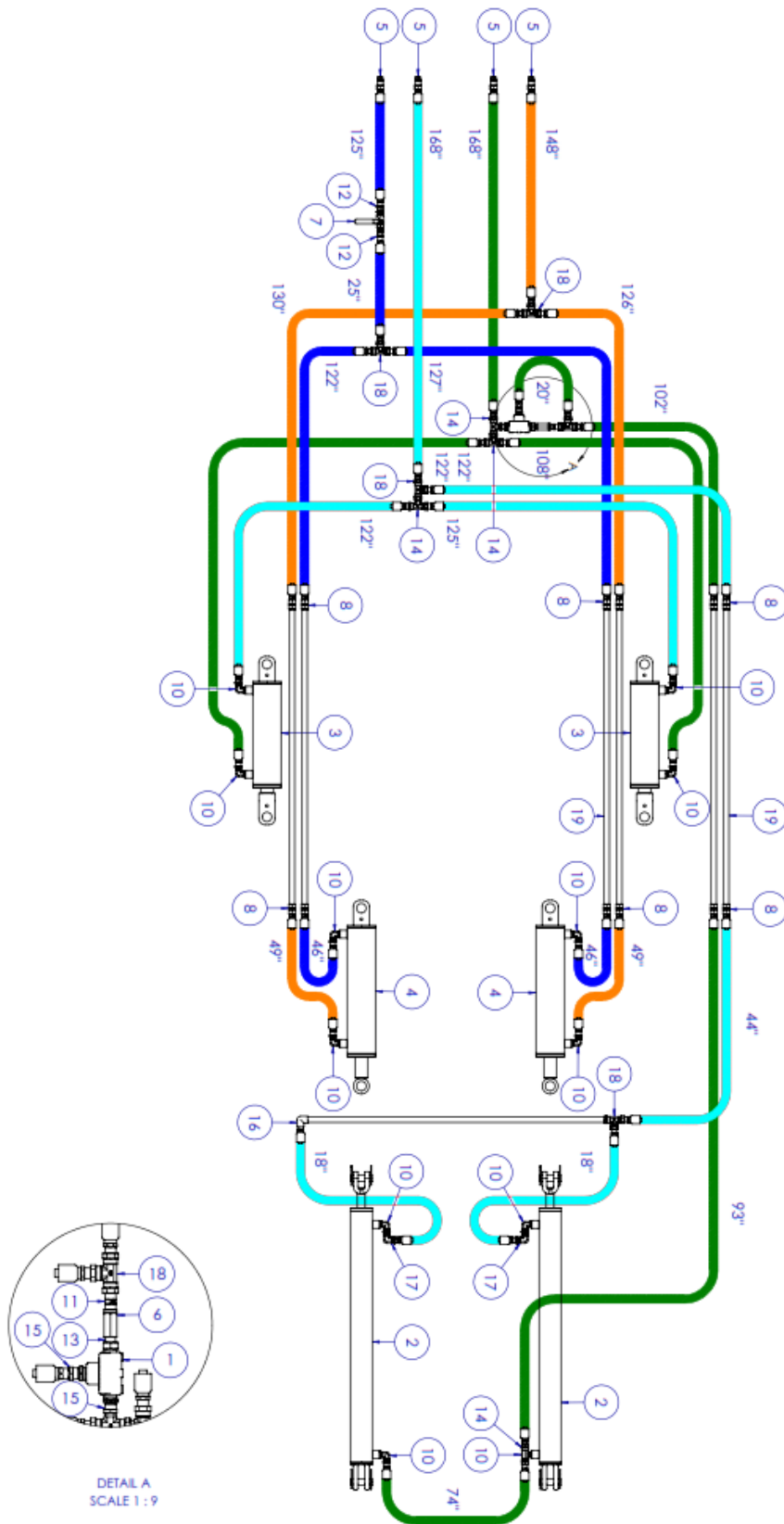



1250 HYDRAULIC SYSTEM

| ITEM | PART # | DESCRIPTION | GCA1250 |
|------|----------------|---|---------|
| | | | QTY |
| 1 | SP4110-3050-01 | 3/4" HYD. RELIEF VALVE (HV34) | 1.00 |
| 2 | SP4110-4050-01 | 3" X 36" X 1-1/2" STROKE HYD. CYL (HCY3X36X112) | 2.00 |
| 3 | SP4110-4094-01 | 4" X 12" X 2" STROKE HYD CYL (HCY4X12X2) | 2.00 |
| 4 | SP4110-4098-01 | 4" X 16" X 2" STROKE HYD. CYL (HCY4X16X2) | 2.00 |
| 5 | SP4110-6012-00 | PIONEER END W/POPPET 1/2"(HEPP) | 4.00 |
| 6 | SP4110-6020-01 | 1/2" HYD CHECK VALVE (HCV12) | 1.00 |
| 7 | SP4110-8020-00 | 1/2" CARBON STEEL BALL VALVE (HBV12) | 1.00 |
| 8 | SP4120-1006-25 | 1/2" FP X 1/2" FP HYD SWIVEL ADAPTOR | 12.00 |
| 10 | SP4120-1016-45 | 1/2 MB X 1/2 FP HYD SWIVEL 90 (HMBFS912) | 12.00 |
| 11 | SP4120-1016-00 | 1/2" MP X 1/2" MP HYD ADAPTOR (HM12) | 1.00 |
| 12 | SP4120-1018-20 | 1/2" MP X 1/2" FP HYD SWIVEL ADAPTOR (HMFS12) | 2.00 |
| 13 | SP4120-1018-00 | 1/2" MP X 3/4" MP HYD ADAPTOR (HM1234) | 1.00 |
| 14 | SP4120-1019-20 | 1/2" MP X 1/2" FP SWIVEL TEE (HTMFS12) | 4.00 |
| 15 | SP4120-1022-20 | 3/4" MP X 1/2" FP HYD SWIVEL ADAPTOR (HMFS3412) | 2.00 |
| 16 | SP4120-1132-80 | 1/2" FP X 1/2" FP HYD 90 ELBOW | 1.00 |
| 17 | SP4120-1168-20 | 1/2" MP X 1/2 FP HYD SWIVEL 90 (HMFS912) | 2.00 |
| 18 | SP4120-1210-85 | 1/2" FP SWIVEL TEE (HTFS12) | 5.00 |
| 19 | GBCA12050009C | SIDE TUBE | 7.00 |
| 20 | SP4430-0120-45 | 8M2T - 8MP - 18" HYD HOSE, ASSEMBLY | 2.00 |
| 21 | SP4430-0120-50 | 8M2T - 8MP - 20" HYD HOSE, ASSEMBLY | 1.00 |
| 22 | SP4430-0120-63 | 8M2T - 8MP - 25" HYD HOSE, ASSEMBLY | 1.00 |
| 23 | SP4430-0121-11 | 8M2T - 8MP - 44" HYD HOSE, ASSEMBLY | 1.00 |
| 24 | SP4430-0121-16 | 8M2T - 8MP - 46" HYD HOSE, ASSEMBLY | 2.00 |
| 25 | SP4430-0121-24 | 8M2T - 8MP - 49" HYD HOSE, ASSEMBLY | 2.00 |
| 26 | SP4430-0121-87 | 8M2T - 8MP - 74" HYD HOSE, ASSEMBLY | 1.00 |
| 27 | SP4430-0122-36 | 8M2T - 8MP - 93" HYD HOSE, ASSEMBLY | 1.00 |
| 28 | SP4430-0122-59 | 8M2T - 8MP - 102" HYD HOSE, ASSEMBLY | 1.00 |
| 29 | SP4430-0122-74 | 8M2T - 8MP - 108" HYD HOSE, ASSEMBLY | 1.00 |
| 30 | SP4430-0123-09 | 8M2T - 8MP - 122" HYD HOSE, ASSEMBLY | 4.00 |
| 31 | SP4430-0123-17 | 8M2T - 8MP - 125" HYD HOSE, ASSEMBLY | 2.00 |
| 32 | SP4430-0123-20 | 8M2T - 8MP - 126" HYD HOSE, ASSEMBLY | 1.00 |
| 33 | SP4430-0123-22 | 8M2T - 8MP - 127" HYD HOSE, ASSEMBLY | 1.00 |
| 34 | SP4430-0123-30 | 8M2T - 8MP - 130" HYD HOSE, ASSEMBLY | 1.00 |
| 35 | SP4430-0123-75 | 8M2T - 8MP - 148" HYD HOSE, ASSEMBLY | 1.00 |
| 36 | SP4430-0124-26 | 8M2T - 8MP - 168" HYD HOSE, ASSEMBLY | 2.00 |

DRAWBAR HOOK-UP

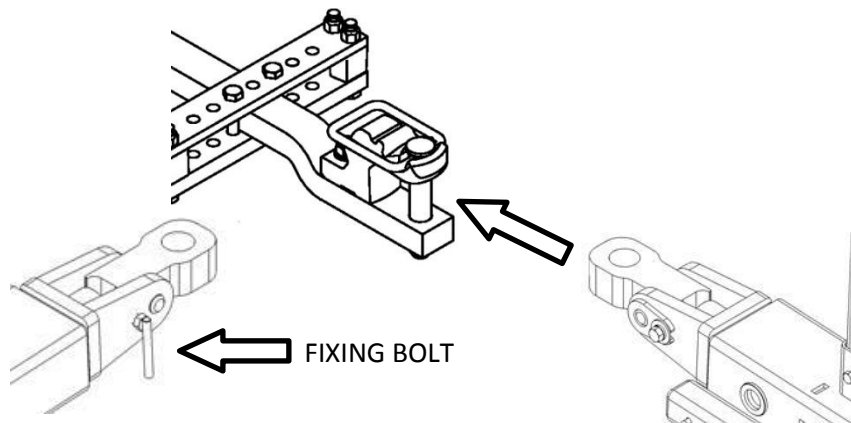

Keep the pull block on horizontal position tightening the fixing bolt. Be sure to loosen the bolt before operating.

There are twenty-two different grease zerks on the machine; one on each cylinder pin; one on each of the rear frame pivot pins; eight on the push gate; one on the ball and receiver; and one on the swivel hitch.

The machine should be greased every four hours or daily, depending on usage.

The wheel bearings should be repacked yearly.

Check air pressure in all tires and kept at minimum of 50 lbs.

Lug bolts should be checked periodically. Refer to "Torque Values Chart" to determine correct torque values when tightening hardware.

| Torque Values Chart for Common Bolt Sizes | | | | | | | | | | | | | |
|---|--------------------------|--------------------|---------|-------|---------|-------|-------------------------|--------------------------|-------|-----------|-------|------------|-------|
| Bolt Size (inches) | Bolt Head Identification | | | | | | Bolt Size (Metric) | Bolt Head Identification | | | | | |
| | Grade 2 | | Grade 5 | | Grade 8 | | | Class 5.8 | | Class 8.8 | | Class 10.9 | |
| in-tpi ¹ | N · m ² | ft-lb ³ | N · m | ft-lb | N · m | ft-lb | mm x pitch ⁴ | N · m | ft-lb | N · m | ft-lb | N · m | ft-lb |
| 1/4" - 20 | 7.4 | 5.6 | 11 | 8 | 16 | 12 | M 5 X 0.8 | 4 | 3 | 6 | 5 | 9 | 7 |
| 1/4" - 28 | 8.5 | 6 | 13 | 10 | 18 | 14 | M 6 X 1 | 7 | 5 | 11 | 8 | 15 | 11 |
| 5/16" - 18 | 15 | 11 | 24 | 17 | 33 | 25 | M 8 X 1.25 | 17 | 12 | 26 | 19 | 36 | 27 |
| 5/16" - 24 | 17 | 13 | 26 | 19 | 37 | 27 | M 8 X 1 | 18 | 13 | 28 | 21 | 39 | 29 |
| 3/8" - 16 | 27 | 20 | 42 | 31 | 59 | 44 | M10 X 1.5 | 33 | 24 | 52 | 39 | 72 | 53 |
| 3/8" - 24 | 31 | 22 | 47 | 35 | 67 | 49 | M10 X 0.75 | 39 | 29 | 61 | 45 | 85 | 62 |
| 7/16" - 14 | 43 | 32 | 67 | 49 | 95 | 70 | M12 X 1.75 | 58 | 42 | 91 | 67 | 125 | 93 |
| 7/16" - 20 | 49 | 36 | 75 | 55 | 105 | 78 | M12 X 1.5 | 60 | 44 | 95 | 70 | 130 | 97 |
| 1/2" - 13 | 66 | 49 | 105 | 76 | 145 | 105 | M12 X 1 | 90 | 66 | 105 | 77 | 145 | 105 |
| 1/2" - 20 | 75 | 55 | 115 | 85 | 165 | 120 | M14 X 2 | 92 | 68 | 145 | 105 | 200 | 150 |
| 9/16" - 12 | 95 | 70 | 150 | 110 | 210 | 155 | M14 X 1.5 | 99 | 73 | 155 | 115 | 215 | 160 |
| 9/16" - 18 | 105 | 79 | 165 | 120 | 235 | 170 | M16 X 2 | 145 | 105 | 225 | 165 | 315 | 230 |
| 5/8" - 11 | 130 | 97 | 205 | 150 | 285 | 210 | M16 X 1.5 | 155 | 115 | 240 | 180 | 335 | 245 |
| 5/8" - 18 | 150 | 110 | 230 | 170 | 325 | 240 | M18 X 2.5 | 195 | 145 | 310 | 230 | 405 | 300 |
| 3/4" - 10 | 235 | 170 | 360 | 265 | 510 | 375 | M18 X 1.5 | 220 | 165 | 350 | 260 | 485 | 355 |
| 3/4" - 16 | 260 | 190 | 405 | 295 | 570 | 420 | M20 X 2.5 | 280 | 205 | 440 | 325 | 610 | 450 |
| 7/8" - 9 | 225 | 165 | 585 | 430 | 820 | 605 | M20 X 1.5 | 310 | 230 | 650 | 480 | 900 | 665 |
| 7/8" - 14 | 250 | 185 | 640 | 475 | 905 | 670 | M24 X 3 | 480 | 355 | 760 | 560 | 1050 | 780 |
| 1" - 8 | 340 | 250 | 875 | 645 | 1230 | 910 | M24 X 2 | 525 | 390 | 830 | 610 | 1150 | 845 |
| 1" - 12 | 370 | 275 | 955 | 705 | 1350 | 995 | M30 X 3.5 | 960 | 705 | 1510 | 1120 | 2100 | 1550 |
| 1-1/8" - 7 | 480 | 355 | 1080 | 795 | 1750 | 1290 | M30 X 2 | 1060 | 785 | 1680 | 1240 | 2320 | 1710 |
| 1-1/8" - 12 | 540 | 395 | 1210 | 890 | 1960 | 1440 | M36 X 3.5 | 1730 | 1270 | 2650 | 1950 | 3660 | 2700 |
| 1-1/4" - 7 | 680 | 500 | 1520 | 1120 | 2460 | 1820 | M36 X 2 | 1880 | 1380 | 2960 | 2190 | 4100 | 3220 |
| 1-1/4" - 12 | 750 | 555 | 1680 | 1240 | 2730 | 2010 | | | | | | | |
| 1-3/8" - 6 | 890 | 655 | 1990 | 1470 | 3230 | 2380 | | | | | | | |
| 1-3/8" - 12 | 1010 | 745 | 2270 | 1670 | 3680 | 2710 | | | | | | | |
| 1-1/2" - 6 | 1180 | 870 | 2640 | 1950 | 4290 | 3160 | | | | | | | |
| 1-1/2" - 12 | 1330 | 980 | 2970 | 2190 | 4820 | 3560 | | | | | | | |

¹ in-tpi = nominal thread diameter in inches-threads per inch
² N · m = newton-meters
³ ft-lb = foot pounds
⁴ mm x pitch = nominal thread diameter in millimeters x thread pitch

Torque tolerance + 0%, -15% of torquing values. Unless otherwise specified use torque values listed above.

OPERATION

The 1250 Carry All scrapers are designed with Category III and IV hitch. Horsepower rating of tractor should be between 200 and 300 hp for the 1250 single and between 250 and 350 hp for the 1250 tandem.

IMPORTANT: You could lose steering control if your tractor is too light. Refer to your tractor's manual to determine if additional ballast is needed.

Follow all laws when transporting on highways and drive slowly over rough ground, side hills, and around curves. Always put transport lock in while traveling down the road.

Watch out for wires, trees, etc., when raising equipment. Make sure all persons are clear of working area.

Hook up to the tractor, cycle all hydraulics and be sure to remove transport locks by raising the scraper with your hydraulics before operating.

Check the oil levels in the tractor hydraulic system and add to maintain the proper level. Care should be used when adding oil or when disconnecting any oil line to keep all dirt out of the oil, as dirt is a major factor in the failure of hydraulic components.

There are two sets of hydraulic controls: The two outside hoses control the raise and lower. The two center hoses operate the clam and the pushgate. The clam will rise completely open, before the pushgate cylinders start pushing, without closing the clam. You can level from 0 to 14 inches by adjusting the height of your scraper and then pushing out your load.

Oil flows first to the clam's cylinders until they are fully extended. Once the cylinders are fully extended, the clam circuits' hydraulic pressure begins to increase. Once the pressure threshold is surpassed (which is adjustable. See adjustment section), the relief valve diverts the oil flow to the pushgate's hydraulic circuit. Once the push gate is completely extended the operator then reverses the tractors hydraulic remote. The check valve allows the clam to close and the push gate could be fully retracted.

SETTING THE VALVES



Remove acorn nut, loosen lock nut and turn adjustment screw counter-clockwise to increase speed of the pushgate.

BLADES

Inspect cutting edges daily. Replace cutting edges when center blade has been worn to approximately 4" and side edges worn to approximately 3".

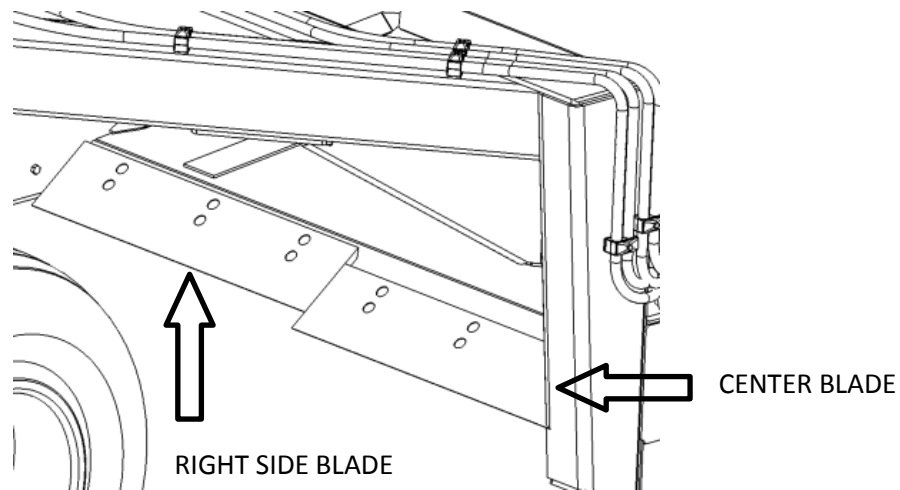

CAUTION

Failure to replace worn cutting edges may result in unnecessary wear to the earthmover sides and floor.

Note: Please specify left or right cutting edges when ordering replacements. Left or right side parts are determined by viewing from rear of the scraper.

When the scraper is placed into operation, the operator will have to "feel out" the amount of depth of cut to obtain maximum loading efficiency. This is usually accomplished by taking a lesser and more uniform cut; however, some soil conditions such as loose sand may require a "pumping action" obtained by taking successive deep cuts and lifting out of cut as the tractor begins to lose power or traction.



WARRANTY

Under the conditions described herein GARFIELD, INC. will within 12 months from the date of purchase on agricultural designed the operated machinery, and 90 days for hire commercial machinery, supply or at GARFIELD's option, repair any part manufactured and/or workmanship, upon receipt of the damaged part.

GARFIELD components manufactured by companies other than GARFIELD are warranted solely by those companies. Those components include but are not limited to tires, rims belts, hoses, and hydraulics.

GARFIELD will not warrant any part which in GARFIELD's opinion has failed due to modifications, abuse, misuse, improper maintenance, or due to normal wear.

GARFIELD will pay no further expenses, including but not limited to transportation, labor and loss of time income, or crops.

This warranty is made expressly in place of all other guarantees or warranties, expressed or implied.



FORWARD

This manual is written as a guide for owners and operators of the GARFIELD equipment, read it carefully and follow the suggestions which are made. Keep this manual in a convenient place for quick, easy reference and use it whenever questions come up.

Fill in the following warranty registration form and return to GARFIELD INC. Keep this information for future reference. Always give this information to your Dealer when ordering new parts, or asking for help. Your GARFIELD dealer is your primary source for information, however, if at any time it is necessary for you to write directly to GARFIELD INC. for additional information, give the model and serial number of your machine and as much descriptive information as possible. This will help us to do a better job of solving your problem and/or getting parts to you.

MODEL NO. _____

SERIAL NO. _____

DATE OF PURCHASE _____

NAME AND ADDRESS _____

It is the policy of GARFIELD INC. to make improvements on our product. GARFIELD, INC. reserves the right to make these improvements without incurring any obligation to those machines already in the field. Years of research and development combined with experience gained through close contact with operators has been drawn upon designing your products.

GARFIELD EQUIPMENT, INC.

500 W. SOUTHGATE

ENID, OKLAHOMA 73701

580-233-1410

800-382-4478